



MANUAL

RECEPTION + OPERATION + MAINTENANCE



TABLE OF CONTENTS.



User Responsibility	3
Standard and optional Features	4
The HighdentIntro™ dental delivery unit.....	5
Receiving, Assembly and Start-up.....	6-11
Handpieces Adjustments	12
Assembled View.....	13
Controls Details	14-15
Units head	14
Compressor	15
Daily Verifications Procedures	16-17
Annual Maintenance	18
Kruise – Intro.....	19
Warranty.....	20

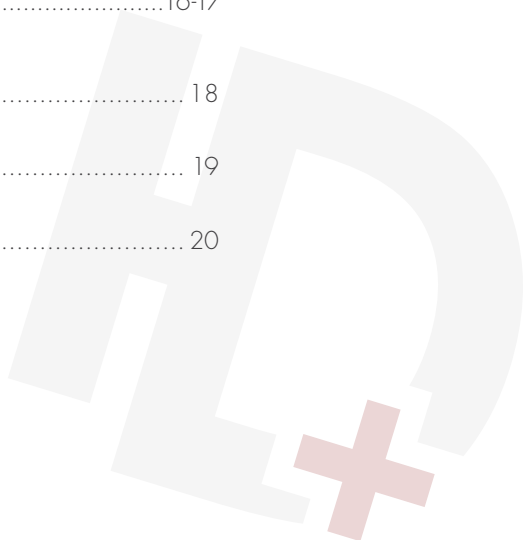

USER RESPONSIBILITY.



Read this manual before operating the equipment. Pay special attention to all Warnings and Cautions.

This product will perform in conformity with the description contained in this operating manual when assembled, operated, maintained and repaired in accordance with the instructions provided. This product must be checked periodically. A defective product should not be used. Parts that are broken, missing, plainly worn, distorted or contaminated should be replaced immediately. Should such repair or replacement become necessary, Dispomed recommends that a telephone or written request for service be made to the nearest Dispomed regional service center. This product, or any of its parts should not be repaired other than in accordance with written instructions provided by Dispomed and by Dispomed trained personnel. The product must not be altered without the prior written approval of Dispomed. The user of this product shall have the sole responsibility for any malfunction which results from improper use, faulty maintenance, improper repair, damage, or alteration by anyone other than a qualified Dispomed technician.

Caution: This device is intended for use by veterinarians who are thoroughly familiar with the use of such products. Do not attempt to use this product if you have not previously been trained on the use of dental units.

THE HIGHTENT INTRO™ DENTAL DELIVERY UNIT.



Standard features include:

- Air/water syringe
- 1 water bottle
- Handpiece guard
- Instrument platter

Product dimensions:

- Length: 43.2 cm (17")
- Width: 52.1 cm (20.5")
- Min. height: 79 cm (31")
- Max. height: 101 cm (40.5")
- Weight: 44.9 kg (99 lb)

Specifications 120V:

- Amps: 7 A
- Power source: 110–120V AC

Optional features:

- Grey + colors options
- Quiet compressor, 40dB, means less noise pollution with compressor oil
- High speed handpieces with handpiece oil and 15 carbides
- Low speed handpieces with handpiece oil, Prophy cup and prophy paste
- Wall-mount



RECEIVING, ASSEMBLY AND START-UP INSTRUCTIONS.



Your Highdent dental unit requires some assembly before being used.

Receiving

To keep the possibility of damage during shipment to a minimum, the KRUUSE unit requires some assembly. All accessories are included in a bag and or small box within the shipping crate.

Instructions

Upon receipt and unpacking, inspect both the shipping container and all of the enclosed components for signs of damage which may have occurred during transit.

Check your materials list to ensure that all the necessary components are included.

Caution: To avoid injury while removing the unit from the box always have another person assist you.



RECEIVING, ASSEMBLY AND START-UP INSTRUCTIONS.



1 Check the compressor oil level through the sight glass at the front of the compressor.



2 If the oil level is less than half, remove the sticker and fill the reservoir slowly by pouring a small quantity of oil at a time. Wait 5 minutes and check the level. Don't forget to reinstall the sticker.

Do not fill more than half.
Use only compressor oil to fill.



3 Carefully open accessories bag and place pedal on floor.

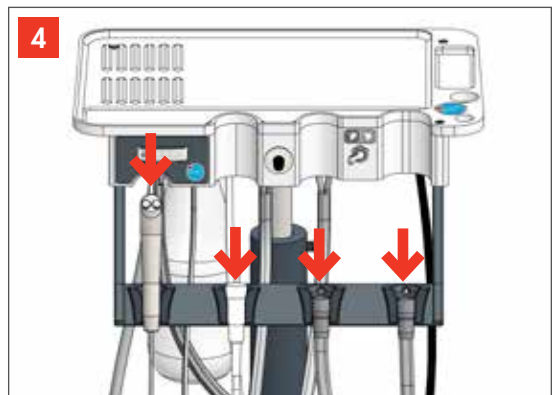

4 Install handpiece tubes to holders starting from the right and following the order in which they are connected to the bottom of the unit.

RECEIVING, ASSEMBLY AND START-UP INSTRUCTIONS.

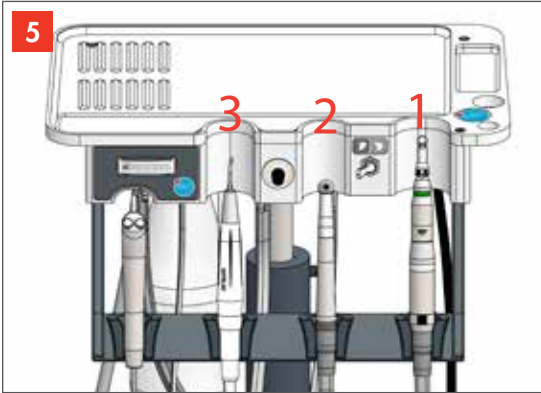

Install handpieces:

- 1: Low speed hanpiece
- 2: High speed handpiece
- 3: Piezo

(Caution: Never run handpiece without tip or bur)

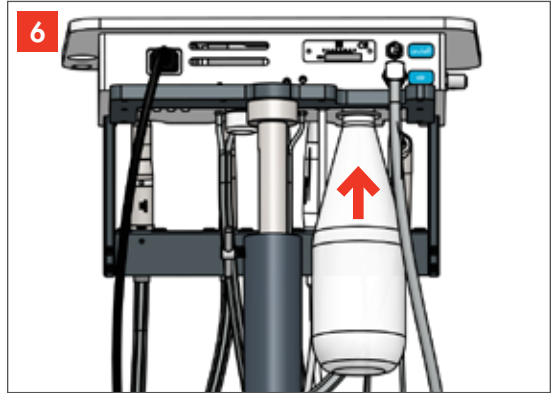

Fill water bottle with distilled water and install under head of unit by inserting drive tube and screwing bottle into place.

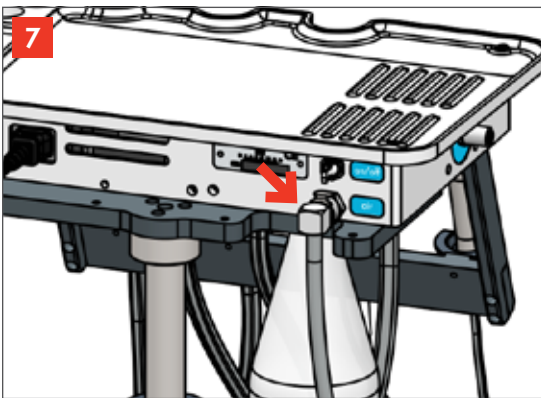

Connect air pressure line to air connector behind head assembly.

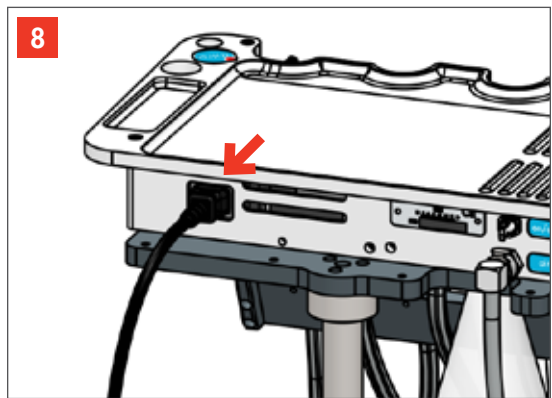

Connect power line on the back of head assembly to the terminal strip on compressor.

RECEIVING, ASSEMBLY AND START-UP INSTRUCTIONS.

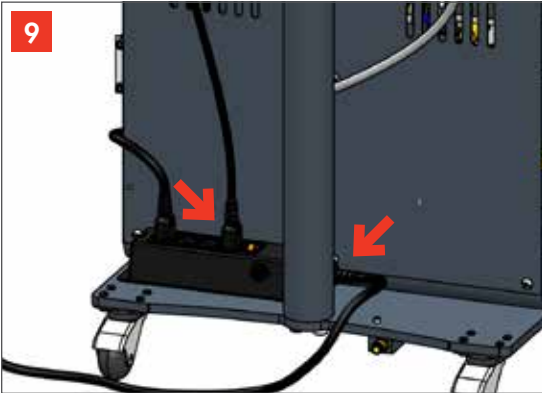

9 Connect the other end of the power line from the head assembly. Connect power cord from bottom of terminal strip to appropriate electrical outlet.



10 Turn compressor on. (On units equipped with oil compressor the switch is near the pressure gauge at the back of the compressor).



11 The gauge should indicate between 80 psi (5.5 bar) and 120 psi (8.3 bar) once compressor has stopped.

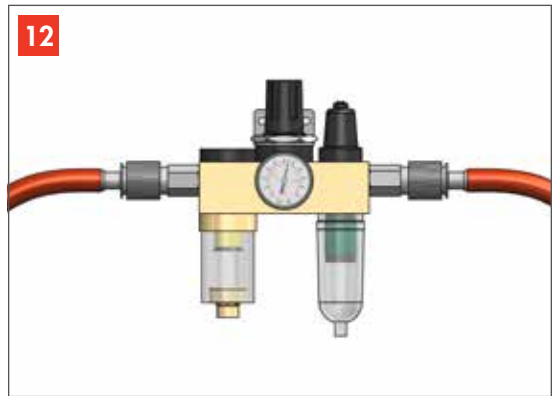

12 If using another air source check for supply pressure of approximately 80 psi (5.5 bar) at source.

RECEIVING, ASSEMBLY AND START-UP INSTRUCTIONS.

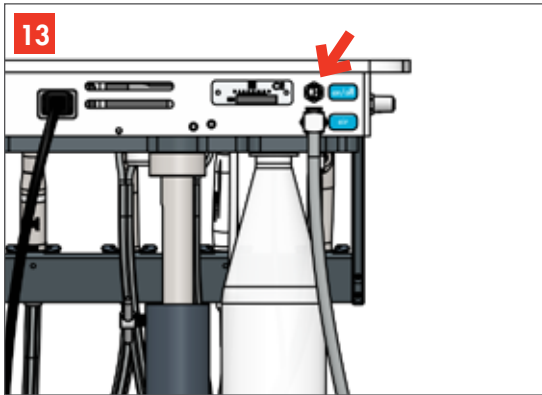

Turn water valve on.

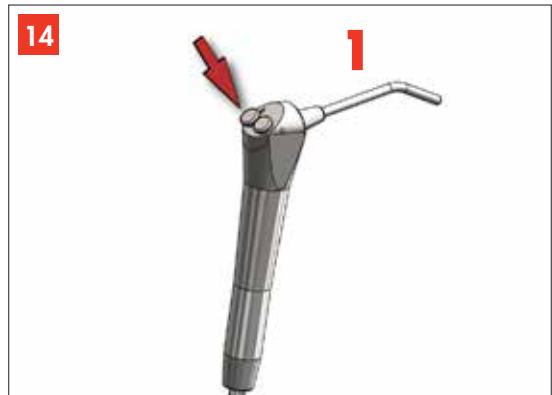

Test syringe by pressing air button then water button then both simultaneously for mist.

1. To sterilize the tip pull it out of the syringe.

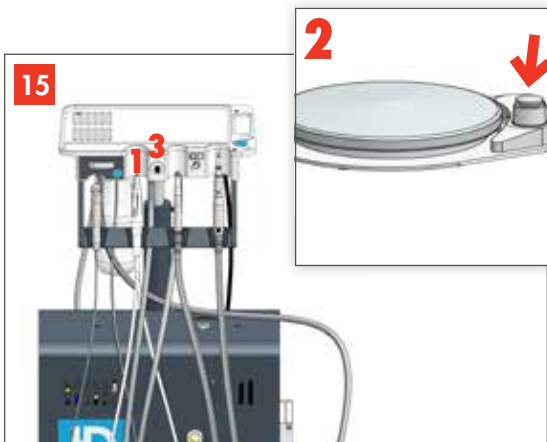

1. Remove Piezo from holder.
2. Depress smaller footswitch.
3. Adjust power according to tip being used.

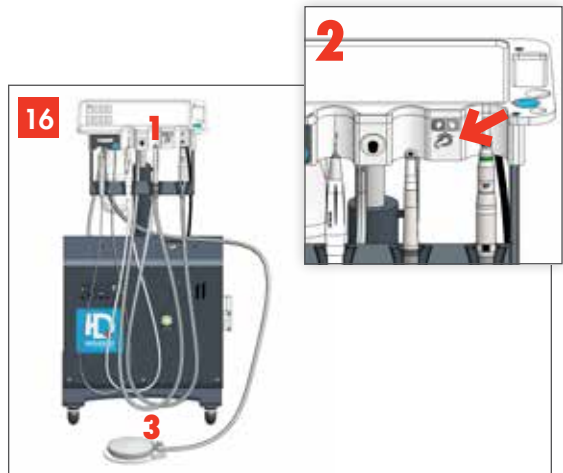

1. Remove high speed handpiece from holder.
2. Position the handpiece selector to high speed.
3. Depress pedal.

RECEIVING, ASSEMBLY AND START-UP INSTRUCTIONS.

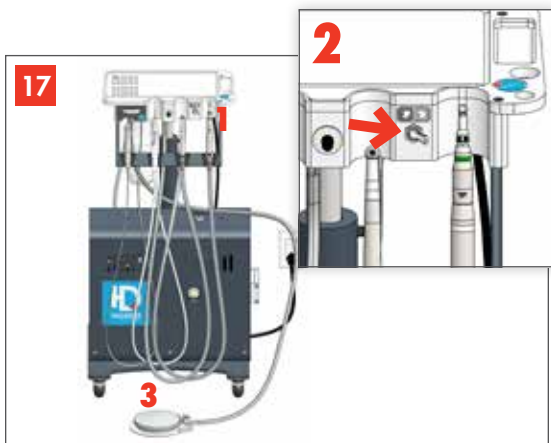

1. Remove low speed handpiece from holder.
2. Position the handpiece selector to low speed.
3. Depress pedal.

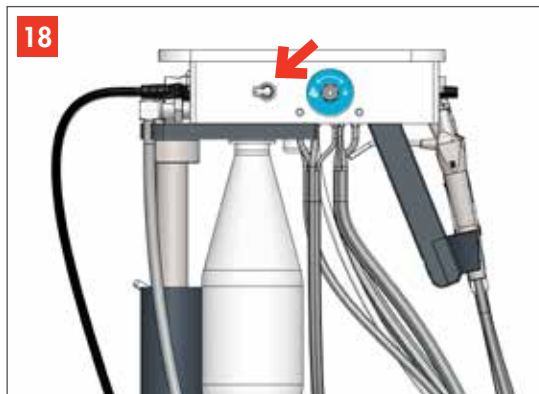

Use the indicated switch to activate the water* on the low speed handpiece.

*The water on the low speed handpiece is optional.

HANDPIECES ADJUSTMENTS.



Adjust handpieces pressure according to the manufacturers specifications.

1. High speed handpiece pressure adjustment
2. Low speed handpiece pressure adjustment

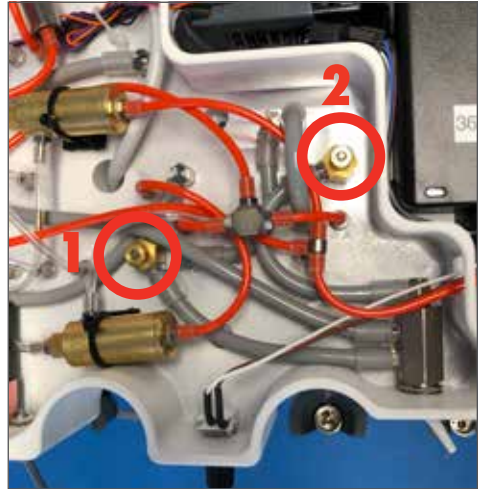

ASSEMBLED VIEW.



UNIT CONTROLS DETAILS.

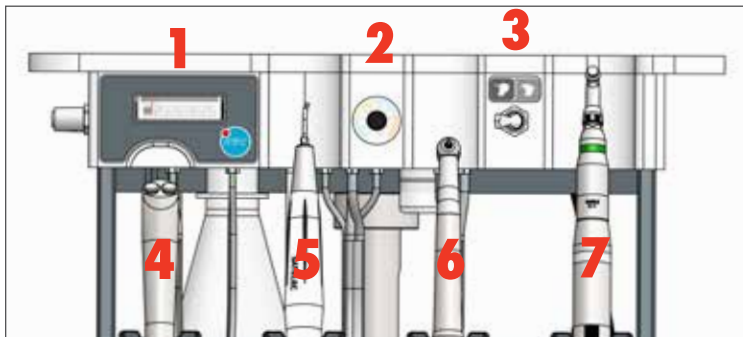

1. Handpiece pressure gauge
2. Piezo power adjustment
3. Handpiece selection
4. Air / water syringe
5. Piezo scaler (For detailed instruction on the piezo handpiece refer to the operation manual supplied with the piezo)
6. High speed handpiece
7. Low speed handpiece

1. High speed handpiece water adjustment

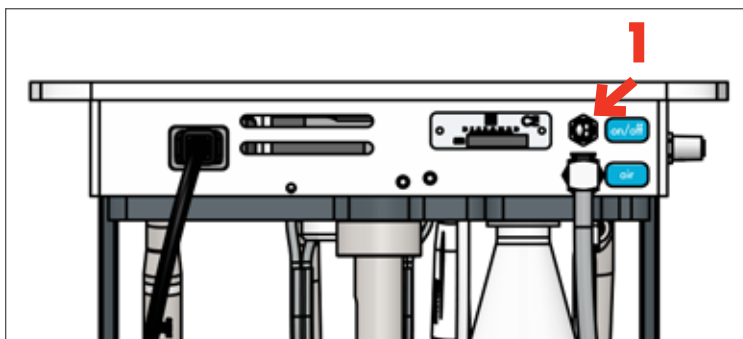
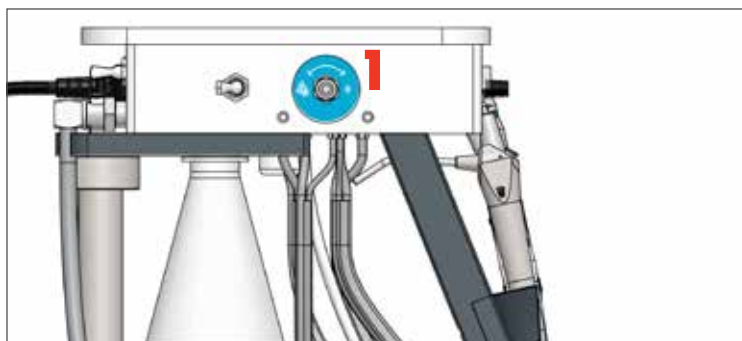

1. Water on/off

COMPRESSOR CONTROLS DETAILS.

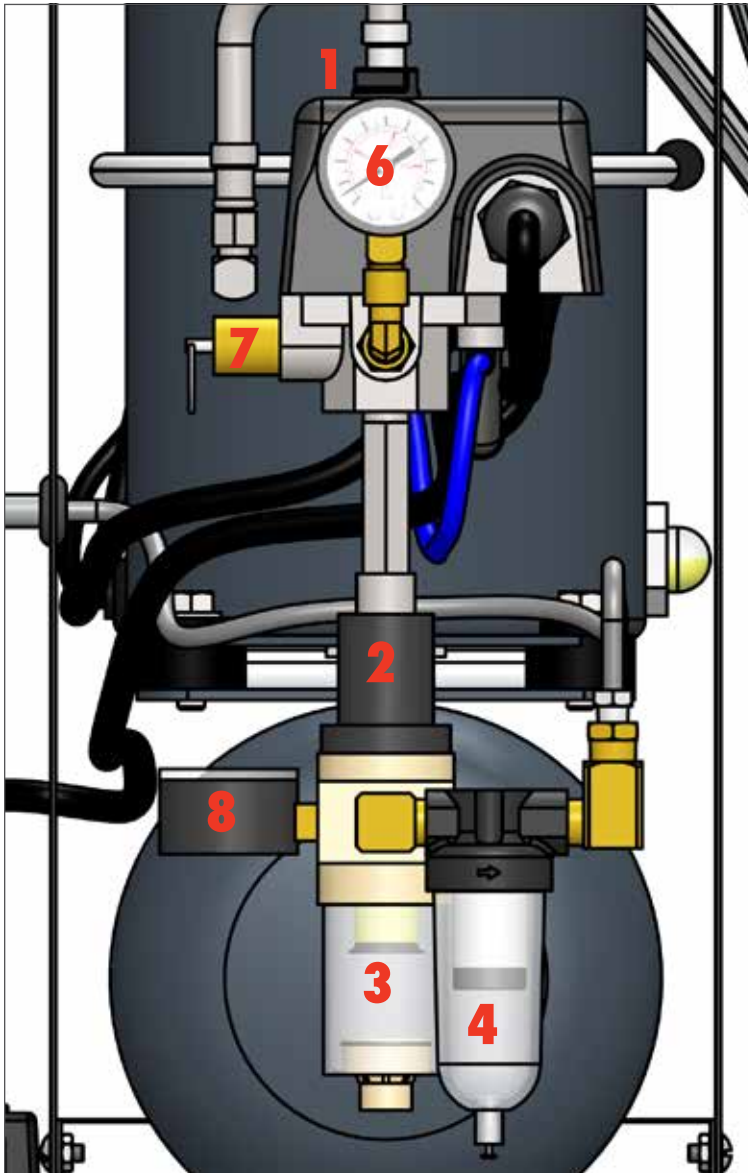

1. Auto/off
2. Regulator adjustment
3. Moisture trap
4. Oil filter
5. Compressor drain
6. Compressor pressure gauge
7. Over pressure valve
8. Delivery pressure gauge (80 psi / 5.5bar)



DAILY MAINTENANCE PROCEDURE.



A properly maintained machine reduces air consumption and extends the life time of the unit.

Prerequisites: Air supply : 5.5 bar (75 to 85 P.S.I) – Electrical : 230 vac.



Lubricate your handpieces as per your manufacturers specifications.

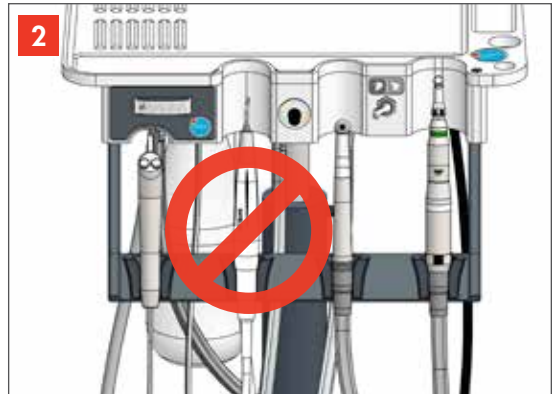

Never lubricate the Piezo.

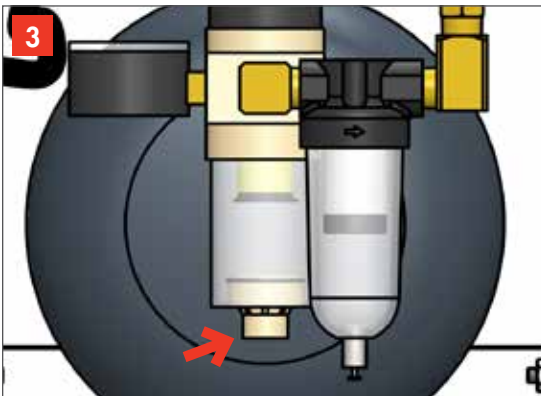

Empty the humidity filter by opening the drain at the bottom.

Use a cloth to avoid getting wet.

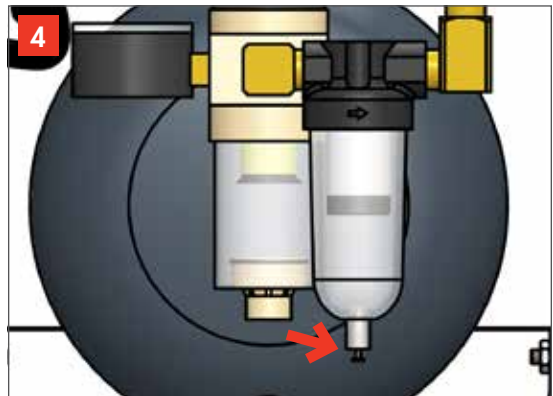

Empty the oil filter by pushing the valve at the bottom.

Use a cloth to avoid getting wet.

DAILY MAINTENANCE PROCEDURE.

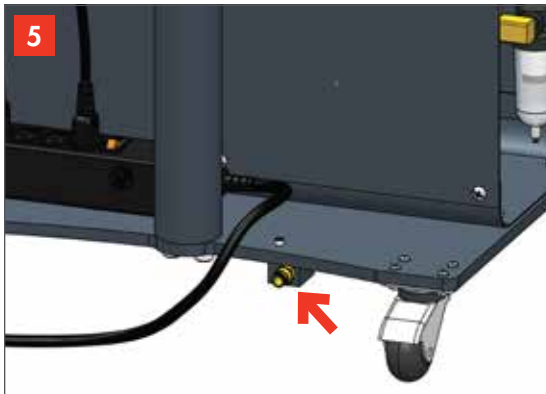

Unplug your compressor at the end of the day and drain all pressure by loosening the hand tight nut* below air reservoir. This will also eliminate condensation and prolong the life of the reservoir.

DON'T FORGET to tighten the hand tight nut before starting your day.

*Don't unscrew completely to prevent the parts falling.



If the oil level is less than half, Fill the reservoir slowly by pouring a small quantity of oil at a time. Wait 5 minutes and check the level.

Do not fill more than half.
Use only compressor oil to fill.



Listen for unusual compressor start-ups. If the compressor starts occasionally when not being used it is a sign that there is a leak in the system. If this situation is frequent contact the manufacturer for assistance.

ANNUAL MAINTENANCE.



An annual preventive maintenance is recommended. The maintenance consists of replacing all filter elements, changing the oil in the compressor, checking for leaks, resetting pressures and complete performance analysis.

Contact your Highdent supplier for further details.

Maintenance kit

- Humidity filter - 260-C01642
- Air filter - 260-C0011
- oil filter - 260-C0164N7
- Compressor oil - 260-15280



DISPOMED WARRANTY.



Dispomed Ltd. guarantees that Highdent dental units are free from manufacturing defects for a period of five (5) years and handpieces for a period of one (1) year from the date of delivery to the customer, provided that they are used according to instructions and that the prescribed maintenance and service are performed.

Dispomed Ltd. shall not be liable for any damage, injury or loss arising out of the use of the product, whether as a result of a defect in the product or otherwise, if, prior to such damage, injury or loss, the product was:

- Damaged, misused or misapplied;
- Repaired, altered or modified by a person other than Dispomed Ltd. or a Dispomed approved service technician;
- Not installed in strict compliance with applicable codes and ordinances.

Dispomed Ltd. only guarantees that plastic, rubber and disposable items parts and items shall be free from defects at the date of delivery to the customer.

Any product which proves to be defective in workmanship or material will, at Dispomed's discretion, either be repaired or replaced. Dispomed Ltd. is not responsible for deterioration, wear or abuse. This warranty shall be void for any product on which the serial number has been altered, defaced or removed.

Freight charges to ship replacement or repaired merchandise to customer will be paid by the customer. Loaner units may be available if your unit requires repairs.

Service & information center

Dispomed Ltd. is proud to offer its customers an on-line or telephone service to answer questions or concerns regarding its products.

Contact us at:

T: 1 800 363-1746

T: 450 759-9395

F: 450 759-8181

Email: info@dispomed.com

Website: www.dispomed.com



DISPOMED

CONTACT INFORMATION

745, Nazaire-Laurin, Joliette (Qc) Canada J6E 0L6

T: 1 800 363-1746

T: 1 450 759-9395

F: 1 450 759-8181

Courriel : info@dispomed.com

Site internet : www.dispomed.com

Twitter : twitter.com/dispomed_fr

Facebook : www.facebook.com/dispomed



Printed in Canada

